



Boundary Type 2  
Timber  
featherboard fence  
Height: 1800mm

N 731072000  
E 716870000  
Origin (0,0)

**LEGEND**

**ARBORICULTURAL IMPACT**

- TREES TO BE RETAINED
- TREES TO BE REMOVED TO FACILITATE DEVELOPMENT
- CATEGORY C TREES TO BE REMOVED IN THE INTERESTS OF IMPROVING PUBLIC SPACE AREAS
- CATEGORY U TREES OF VERY LOW VALUE AND QUALITY TO BE REMOVED IN THE INTERESTS OF SOUND ARBORICULTURAL MANAGEMENT

- SITE BOUNDARY
- UNDERGROUND SERVICES
- BASEMENT

DRAWING TO BE INTERPRETED WITH REFERENCE TO THE ARBORICULTURAL ASSESSMENT AND IMPACT REPORT

**KEYPLAN**

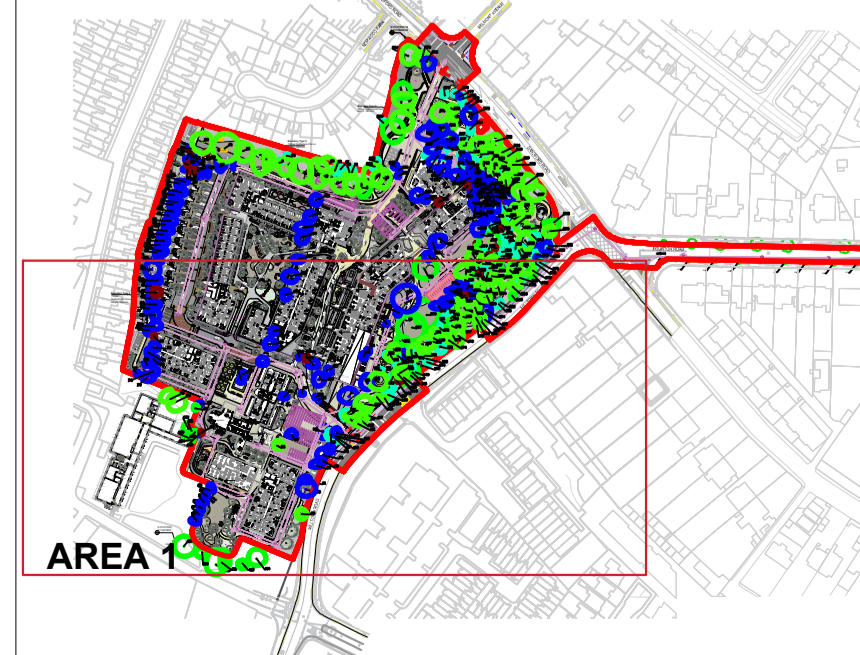

REV	DATE	DESCRIPTION
B	24-06-20	Modified impacts for attenuation tanks and related services.
C	04-08-20	Modified impacts for attenuation tanks and related services.
D	05-08-20	Amended client and address titleblock details, updated underground services reference.
E	06-01-21	Adjusted position of underground services tank east of building A.
F	07-04-21	New survey information from update report.
G	11-08-21	New landscaping inputs

<b>CMK</b> Horticulture & Arboriculture Ltd		PROJECT: MILLTOWN PARK, SANDFORD ROAD, DUBLIN 6		JOB NO: TSAN001
		Client: SANDFORD LIVING LIMITED	DRAWING: Arboricultural Impact (1 of 2)	
NOTES: <small>The information contained in this drawing is the property of CMK Horticulture &amp; Arboriculture Ltd. It is to be used for the project and site only. It is not to be used for any other purpose without the written consent of CMK Horticulture &amp; Arboriculture Ltd.</small>		DRAWN BY: Neil McBride	NMB INITIALS	REVISION: 0
<small>© THIS DRAWING IS COPYRIGHT OF CMK HORTICULTURE &amp; ARBORICULTURE LTD.</small>		STATUS: PLANNING		